



COMMONWEALTH OF PENNSYLVANIA

PENNSYLVANIA GAME COMMISSION

FIELD REGIONS

253 Snyder Road
Reading, PA 19605
January 25, 2019

REQUEST FOR BIDS
FOREST MOWING
PGC SOUTHEAST REGION

Prospective Service Contractors:

The Southeast Region of the Pennsylvania Game Commission is soliciting bids for the mowing of 118 acres on four game lands located in Dauphin, Lancaster, Lebanon and Schuylkill Counties. The location of the project is defined on the attached map. Specifications are detailed in Attachment 1 of the bid packet.

Bids are to be submitted electronically thru the Commonwealth's "PA Supplier Portal" system **by 2 PM March 5, 2019**. If you have not registered as a vendor with the state, you must do this first at www.pasupplierportal.state.pa.us before submitting an electronic bid. Any questions regarding this may be directed to Michelle Briel at 610-926-3136 x 6020 mbriel@pa.gov.

Service bid should be by a Unit Price (acre) as well as the total bid price for the project. Payment will be dispersed based on the number of acres completed as per the required specifications. **The work may begin after PO is received and performance bond is provided and the work must be completed by June 27, 2019. No extension of time will be awarded.**

The attached Bid Prospectus provides all necessary specifications, instructions, contact information, map, etc.

Please contact me if you have any questions.

Randall Bauman
Regional Forester
Office: 610-926-3136 X 6686
Cell Phone 717-413-1362
Email: rbauman@pa.gov

**GENERAL SPECIFICATIONS
PENNSYLVANIA GAME COMMISSION
FORESTRY DIVISION**

**FORESTRY MOWING CONTRACT
(MACHINE OR HAND)**

I. SCOPE OF WORK:

- A. The Pennsylvania Game Commission, Southeast Region Forestry Division, requires the services of an Operator to cut interfering woody vegetation at several locations containing 118 acres. Services shall include, but are not limited to, the furnishing of all materials, labor, equipment, tools, superintendence, miscellaneous items, and performing all work necessary to complete the project to the satisfaction of and subject to the approval of the Commission.
- B. Questions regarding any technical aspects of this bid should be directed to the respective Foresters as identified below. Questions regarding administrative aspects of this bid should be directed to Randall Bauman, PA Game Commission Southeast Regional Forester, at telephone no. 610-926-3136 ext. 6686.
- C. Bids are to be submitted electronically thru the Commonwealth's "PA Supplier Portal" system **by 2 PM March 5, 2019**. If you have not registered as a vendor with the state, you must do this first at www.pasupplierportal.state.pa.us before submitting an electronic bid. Any questions regarding this may be directed to Michelle Briel at 610-926-3136 x 6020 mbriel@pa.gov.

II. CONTRACT TASKS:

- A. Project Location(s):
 - 1. Approximately **118** acres on four blocks on the State Game Lands identified in the attached maps.
 - 2. Game Lands Included:
 - SGL 052, Lancaster County – 53 acres.
 - SGL 106, Schuylkill County – 22 acres.
 - SGL 145, Lebanon County – 33 acres.
 - SGL 246, Dauphin County – 10 acres.

III. SITE INSPECTION AND ASSISTANCE:

An optional site inspection tour for each location is highly encouraged and may be conducted by contacting the Forester to make an appointment or get directions to the site:

SGL 052 and SGL 246: Andy Weaver 717-756-1471

SGL 106 and SGL 145: Curtis Noll 610-413-1706

The site inspection will attempt to provide prospective bidders with a perspective on conditions common to all projects, including vegetation for control, topography, site challenges (rock, downed logs, density of reserved trees, etc.) **Not all sites on contract may be shown at the site inspection, therefore bidders are strongly encouraged to visit all sites on their own prior to bidding.**

IV. COMMISSION PERSONNEL - The Commission will furnish personnel to supervise and direct the operation in the following capacities:

- a. **PROGRAM SUPERVISOR** - The Regional Forester of the PA Game Commission Southeast Region is responsible for the overall operation of the vegetation control program and represents the Commission in settling minor contractual matters.
- b. **FIELD CONTRACT COORDINATORS** - These persons are Regional Foresters or their designee who serve as the Commission's field liaison with the Operator and are responsible for reviewing and approving/disapproving the operations plan and conducting quality control checks on the equipment and performance during the operations. This person is responsible for coordinating the activities of all people working on the contract within a region and communicating with the Operator's project supervisor concerning any operational problems or changes in plans. He/she also provides daily reports of the operation to the program supervisor

V. EQUIPMENT SPECIFICATIONS:

- a. Any machine equipment to be used for this project must be a forestry type mowing machine with suitable cutting devices such as a "hydroax", "Fecon", or other suitable cutting head mounted on a machine capable of negotiating forest terrain. All machines used for this project must be of at least 95hp. The Commission reserves the right to reject any piece of equipment that in its opinion will not safely and adequately complete the job.

VI. CONTRACT REQUIREMENTS:

- All **shrubs, vines** and **trees** under 7" diameter at breast height must be felled. All employees must be able to identify species.
- Woody material felled using a mechanical flail type system may not have stumps with clean, sharp cuts and edges and must be less than twelve (12) inches, except when in the opinion of the Field Contract Coordinator, said height is impractical.
- Woody material felled with clean cuts must have stumps that are parallel to the ground surface and shall not exceed six (6) inches in height measured on the side next to the highest ground or the diameter of the stump, whichever is smaller, except when in the opinion of the Field Contract Coordinator, said height is impractical.
- Cut trees must be removed from trails, roads, tail drains, streams, and utility rights-of-way.
- The Operator shall exercise care and caution in all operations to prevent damage to all trees not specified for treatment.
- Damage to trails, roads, streams, or utility rights-of-way caused by the Operator's equipment must be repaired by the Operator at their expense.
- Any trash resulting from the Operator's operations must be removed from the area and properly disposed.
- The Operator shall not block any roads or trails in the area during performance of this contract. The Operator shall not in any way hinder the progress of any Timber Sale Contracts in these areas.
- All labor, equipment, tools, etc., needed to complete contracted projects are to be provided by the Operator.

- Timber Damages – when in the opinion of Field Contract Coordinator, damage to the residual stand becomes excessive, the Operator shall pay the Commission a fair base current value determined by the Field Contract Coordinator per unit of volume. If this value for damage due to Operator’s carelessness or negligence is less than \$10.00 per tree, then a minimum charge of \$10.00 per tree will be made whether the tree is commercial, non-commercial, merchantable, or non-merchantable.

VII. INSURANCE REQUIREMENTS:

- A. The contractor will provide Workmen’s Compensation insurance sufficient to cover all the employees of contractor working to fulfill this contract.
- B. Comprehensive General Liability Insurance, including bodily injury and property damage insurance, to protect the Commonwealth and the contractor from claims arising out of the performance of the contract. The amount of bodily injury insurance shall not be less than \$300,000.00 for injury to or death of persons per occurrence. The amount of Property Damage Insurance shall not be less than \$300,000.00 per occurrence.

Such policies shall name the Commonwealth as an additional insured. Prior to the commencement of work under this contract, the contractor must provide the Commonwealth with current Certificates of Insurance. These Certificates shall contain a provision that coverages afforded under the policy shall not be canceled or changed until at least thirty (30) days prior written notice has been given to the Commonwealth.

The Commonwealth shall be under no obligation to obtain such certificates from the Operator(s). Failure by the Commonwealth to obtain the certificates shall not be deemed a waiver of the Operator’s obligation to obtain and furnish certificates. The Commonwealth shall have the right to inspect the original insurance policies.

VIII. HOLD HARMLESS:

- A. The contractor shall be responsible for and agrees to indemnify and hold harmless the Commonwealth from and against damages to property or injuries (including death) to any persons and other losses, damages, expenses, claims, demands, suits, and actions by any party against the Commonwealth in connection with the work performed by the contractor.

IX. BIDDING

A. RECEIVING AND OPENING BIDS –

Service Bid on the mowing project should include the Unit Price (\$/Acre) as well as total for 118 Acres. Payment will be by Unit (acre) completed to the specifications of Attachment 1.

Bid will be awarded to the lowest total amount.

Bids are to be submitted electronically thru the Commonwealth’s “PA Supplier Portal” system by **2:00 PM, Tuesday March 5, 2019.** If you have not registered as a vendor with the state, you must do this at www.pasupplierportal.state.pa.us prior to submitting an electronic bid.

The Commission reserves the right to reject any or all bids.

ALL VENDORS WHO CONDUCT BUSINESS WITH THE PENNSYLVANIA GAME COMMISSION MUST HAVE A VENDOR NUMBER ASSIGNED TO THEM IN ORDER TO RECEIVE PAYMENT FROM THE COMMONWEALTH.

Vendors may access the website www.pasupplierportal.state.pa.us or phone (877) 435-7363 or (717) 346-2676 or email ra-srmhelp@state.pa.us for assistance to register as a new vendor or, if you are an existing vendor, to change a name or remit to address. This is a Dept of General services (DGS) website so you need to contact them directly if you have any problems with the website.

The unit price (acre) shall include all labor, equipment, tools, insurance and all items necessary for the completion of the project.

B. **BID RESULTS** - Bidders can obtain results at www.emarketplace.state.pa.us/bidtabs.aspx

The posted results will contain the information of the apparent bidders, and all bids are under review until final award of the purchase order.

Quantities herein are only estimates and may increase or decrease dependent upon the needs of the Commission. Operator shall be paid at the unit price bid for actual services performed.

The Commission reserves the right to reject any or all bids and award contracts as it determines to be in the best interest of the Commission.

X. PERFORMANCE SECURITY:

- A. As further guarantee of faithful performance of the conditions set forth in this contract, the Contractor hereby agrees to furnish the Commission with Certified Check, Savings Account, Irrevocable Letter of Credit, or other security acceptable to the Pennsylvania Game Commission, in the sum of **\$5,000.00.**

ANY SECURITY POSTED MUST HAVE AN **EXPIRATION DATE A MINIMUM OF ONE YEAR BEYOND THE EXPIRATION DATE OF THE CONTRACT.**

- B. Performance Security is due no later than 30 days after written notice of the bid award. Time is of the essence with regard to the provision of Performance Security. At the option of the PGC, failure to provide an acceptable Surety within 30 days will result in cancellation of the contract and the PGC may declare the bidder ineligible on future projects.
- C. It is further agreed that any performance bond guarantees the complete and faithful performance of this contract and full compliance with the conditions set forth herein, particularly as to construction repairs, restorations or other conditions to be performed and the Principal and Surety shall in no way be released or either of them, their executors, administrators, successors or assigns from their liability hereunder, notice to the Surety or Sureties of any such repair involving construction restoration and conditions to be performed, and extension or forbearance hereof being hereby waived.
- D. Failure to comply with any of the conditions of the contract herein mentioned shall result in cancellation of the agreement and forfeiture of the performance bond to cover damages sustained by the Commission. The Commission may declare the Contractor ineligible to bid on future contracts.

XI. OPERATOR REFERENCES:

After the bid opening and prior to awarding of the contract, the Commission has the right to request 3 references (names, addresses, and telephone numbers) of similar work performed by the Operator within the previous two (2) years as proof of qualifications to perform the work involved in this contract. Similar work is defined here as proof that the bidder has successfully completed at least 150 acres of machine and/or hand cut mowing in a forested environment in

a single calendar year.

XII. CONTRACT TERM:

The Contract shall commence upon execution and receipt of the performance bond and continue until June 27, 2019. No contract extensions will be approved. Forfeiture of the performance bond will occur if contract is not completed by June 27, 2019.

XIII. PAYMENT TERMS:

Payment shall be on a reimbursement basis for actual acres completed as measured by a Forestry Division employee. A block will be deemed complete when all items listed in the specifications have been met for that block. Invoice must state the number of acres properly treated.

XIV. INVOICES:

Original invoices must be sent to:
Commonwealth of PA – PO Invoices
P.O.Box 69180
Harrisburg, PA 17106

A copy of all invoices must be sent to:

Randall Bauman
SE Regional Forester
Pennsylvania Game Commission
253 Snyder Road
Reading, PA 19605
rbauman@pa.gov

All invoices must have the Purchase Order Number, as well as the Operator's SAP Vendor Number on the invoice. The name and address listed on the purchase order must also be on each invoice. Failure to provide this information may result in a delay of payment.

Please Note: Vendors are reminded to **NOT** include employer identification numbers, Social Security Numbers, bank account information, or other personally identifiable information on their invoices. That information is uniquely tied to your SAP Vendor Number and, for security purposes, should not be explicitly stated on an invoice.

XV. PURCHASE ORDER(S) TERMINATION

The Commonwealth may terminate the Purchase Order(s) for its convenience if the Commonwealth determines termination to be in its best interest. Operator shall be paid for work completed.

Attachments:

Attachment 1: Forest Mowing Specifications

Attachment 2: Project Maps

Attachment 1---Forest Mowing Specifications

1. This project requires the contractor to mow/clear approximately 118 acres of invasive plants, vines and small trees under 7 inches diameter at breast height in woodland understories on four game lands in the southeast region of the PA Game Commission. The contractor may use mechanized equipment as well as handheld tools as ground conditions dictate. **Due diligence will be used by all personnel to protect non-target/desirable species.**
2. The 118-acre project consists of multiple units as shown on the attached maps.
3. After the successful bidder receives the PO and supplies the required bond, the contractor may begin work. **Work must be completed by June 27, 2019.**
4. The contractor shall notify the PGC Regional Forester, Randall Bauman at least three days (72 hours) prior to beginning the project. The contractor may work at times other than the schedule of the PGC representative.
5. The contractor and on-site crew supervisor or foreman will meet with a forestry representative before any work is done to review project specifics.
6. All stems must be cut off completely to no more than 6 inches above ground level, lower is desired.
7. A representative of the contractor, with the ability to communicate easily and effectively with PGC representatives, both orally and in writing in the English language, and with the ability to communicate easily and effectively with all workers on the crew, shall be present at all times at the work site.
8. Damage to non target species will be the responsibility of the contractor. When in the opinion of Regional Forester, damage to the residual stand becomes excessive, the Operator shall pay the Commission a fair base current value determined by the Regional Forester per unit of volume. If this value for damage due to Operator's carelessness or negligence is less than \$10.00 per tree, then a minimum charge of \$10.00 per tree will be made whether the tree is commercial, non-commercial, merchantable, or non-merchantable.
9. Contractor will be responsible to repair excessive damage to roads, work areas, gates or other structures.
10. The contractor will remove all trash and garbage, personal and otherwise, generated from the completion of this contract and dispose in a proper manner.
11. The contractor shall comply with all SGL (State Game Lands) rules and regulations.
12. All equipment will be cleaned of soil and debris before being moved onto site to prevent spread of invasive species.
13. No work days include all Saturdays beginning April 20 through May 31, 2019.
14. The contractor shall notify the Regional Forester upon completion of the work at each site to schedule a final inspection. Inspection will occur during normal working hours. All equipment used for the project will remain on site until the final inspection is completed.

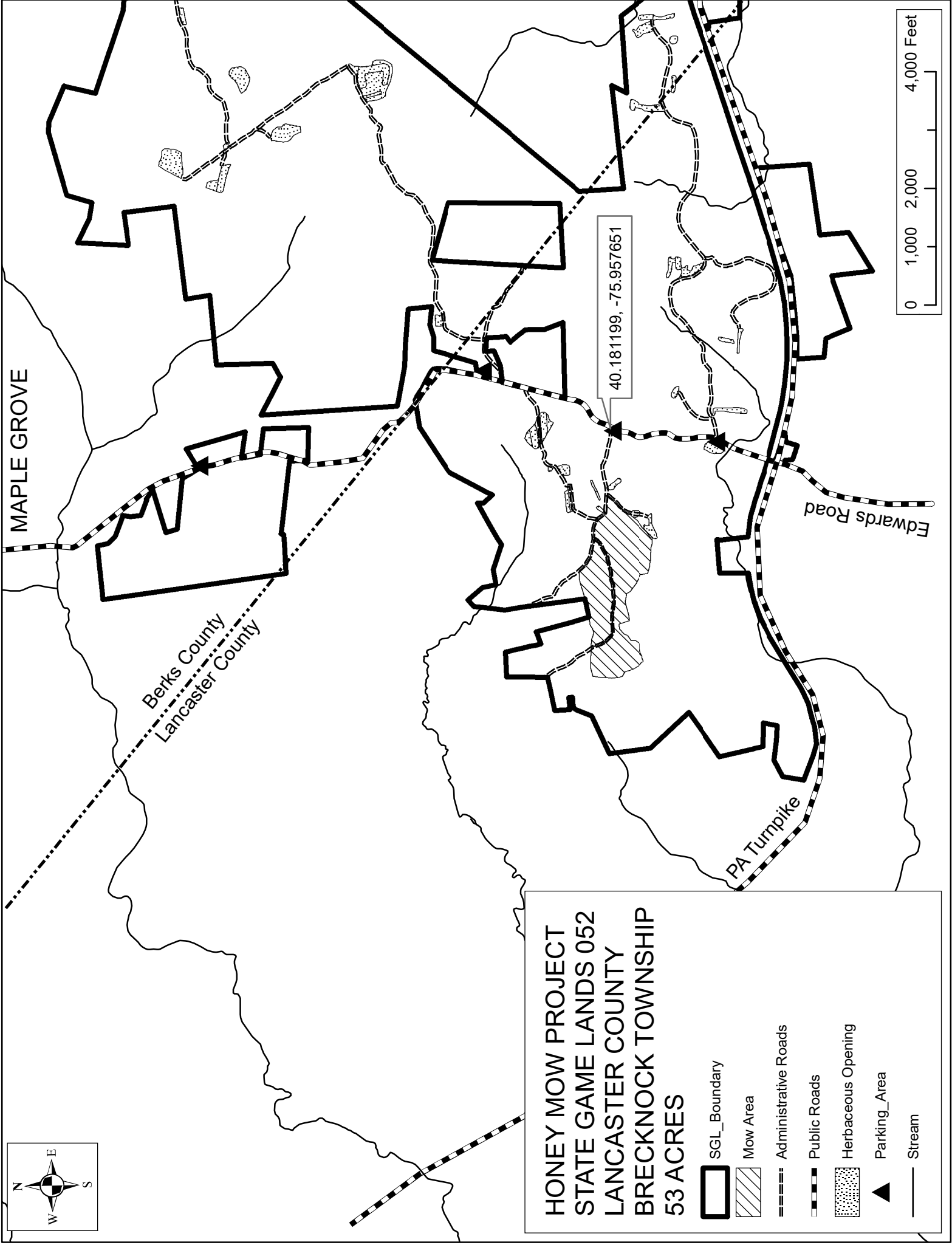

MAPLE GROVE

Berks County
Lancaster County





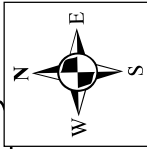
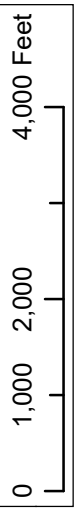

40.181199, -75.957651

PA Turnpike

Edwards Road





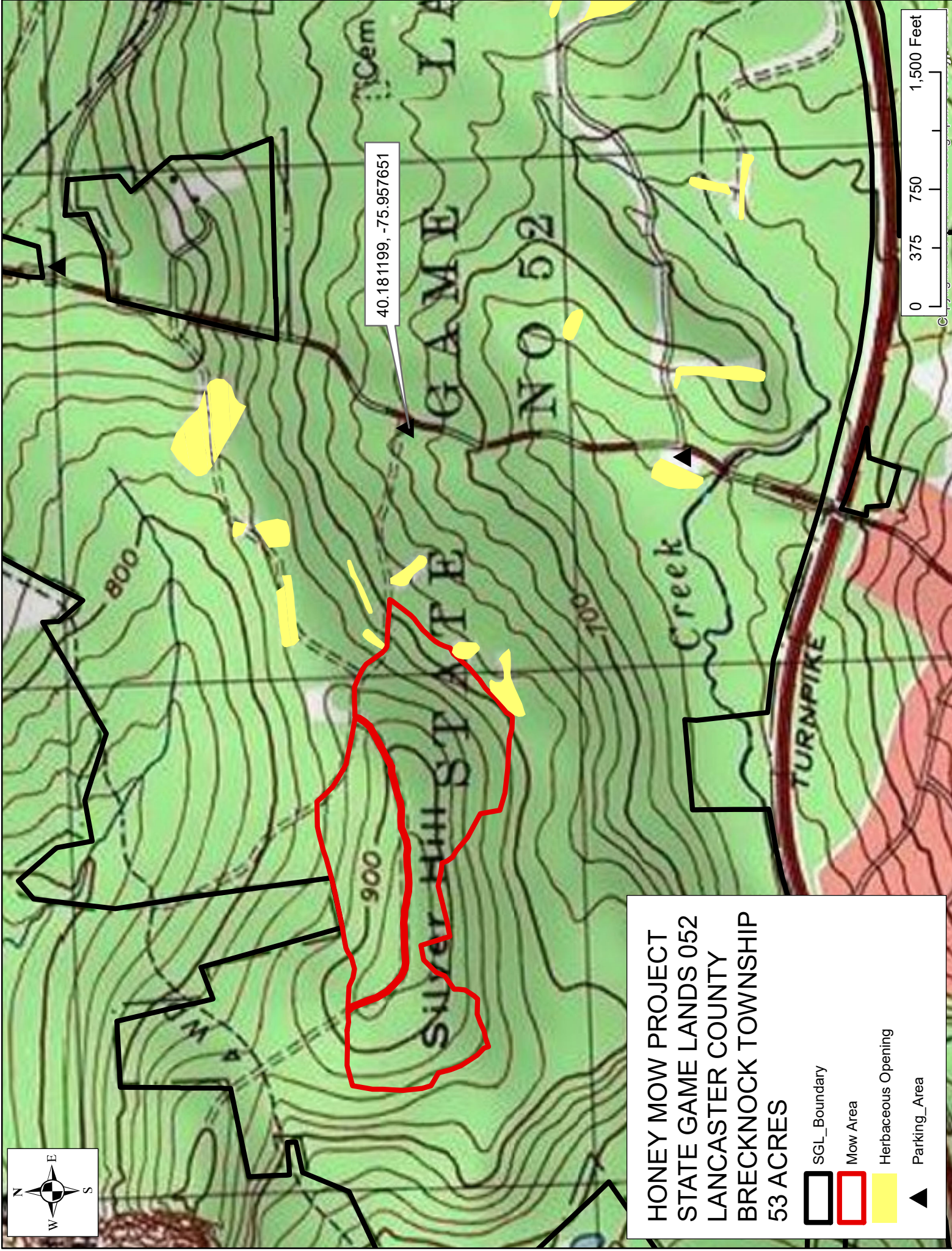

**HONEY MOW PROJECT
STATE GAME LANDS 052
LANCASTER COUNTY
BRECKNOCK TOWNSHIP
53 ACRES**

-  SGL_Boundary
-  Mow Area
-  Administrative Roads
-  Public Roads
-  Herbaceous Opening
-  Parking_Area
-  Stream



40.181199, -75.957651

HONEY MOW PROJECT
STATE GAME LANDS 052
LANCASTER COUNTY
BRECKNOCK TOWNSHIP
53 ACRES

	SGL_Boundary
	Mow Area
	Herbaceous Opening
	Parking_Area

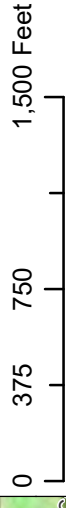

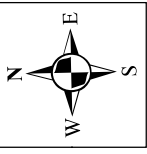

Hawk Mountain Rd

Rockland Road

Summer Valley Rd (Rt 895)

Rt 61

Schuykill County
Berks County

DREHERSVILLE

PORT CLINTON

40.628641, -76.011545

SCARECROW MOW PROJECT
STATE GAME LANDS 106
SCHUYLKILL COUNTY
WEST BRUSWICK TOWNSHIP
22 ACRES



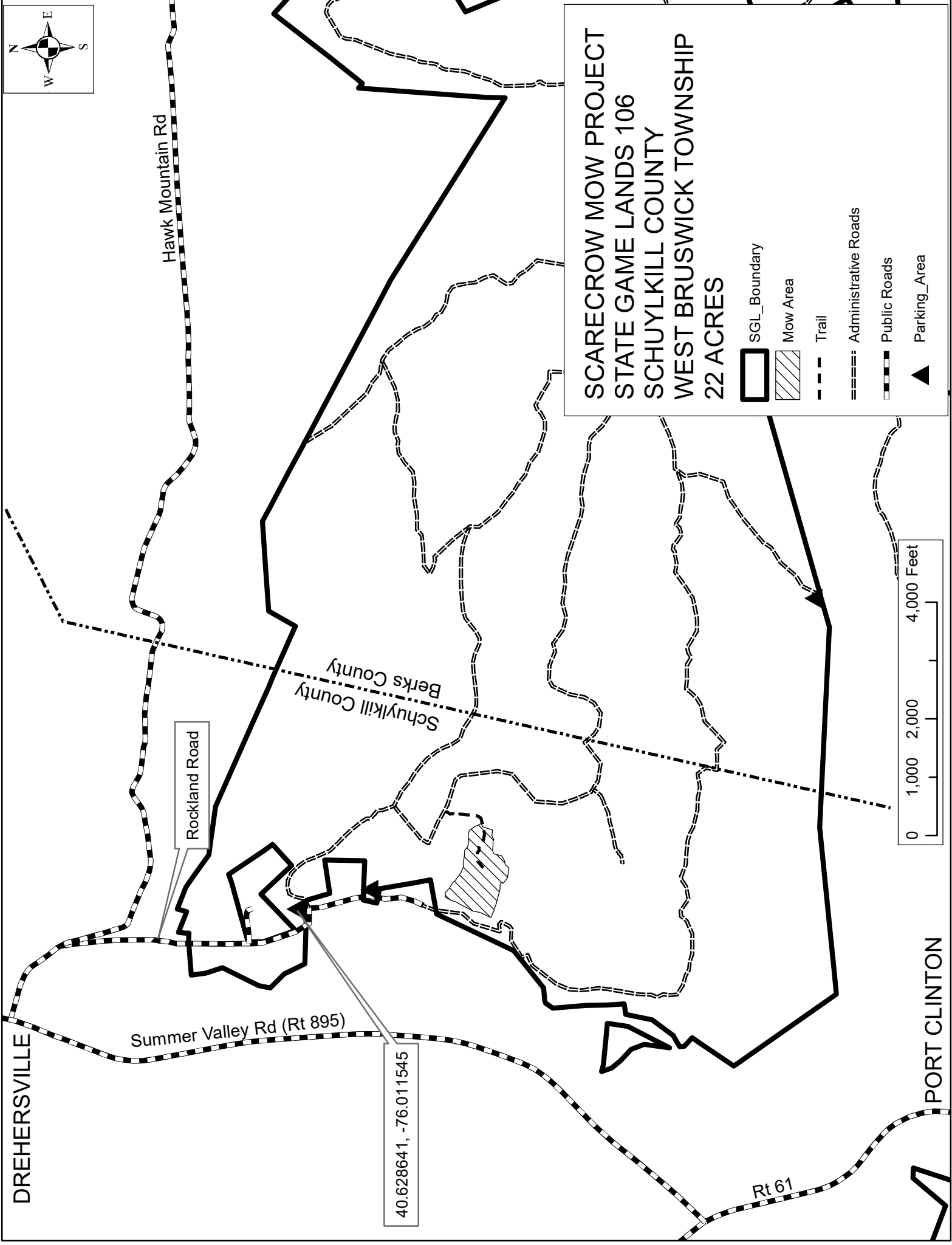
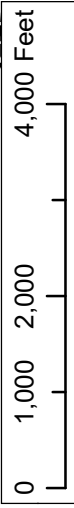

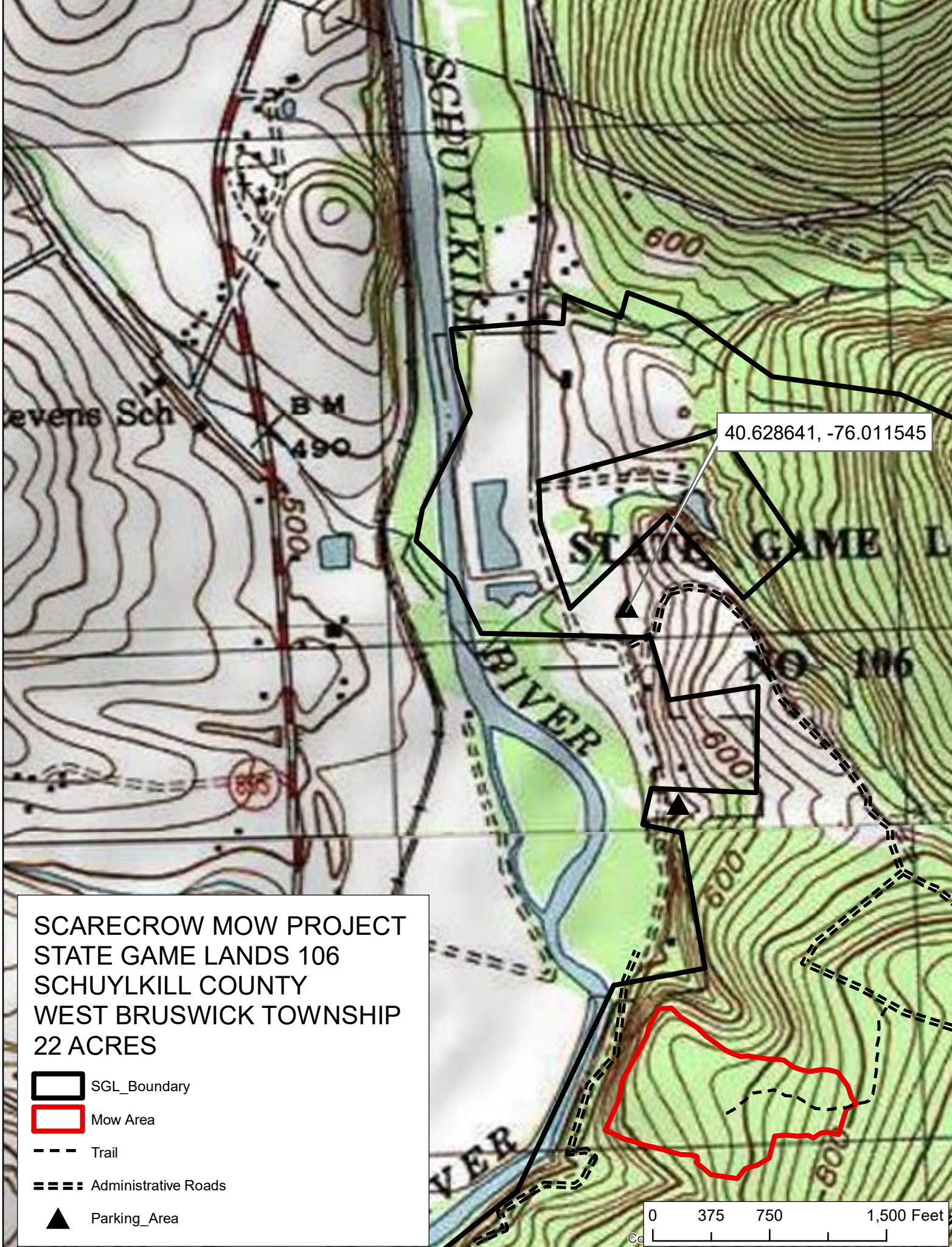
- SGL_Boundary
- Mow Area
- Trail
- Administrative Roads
- Public Roads
- Parking_Area





40.628641, -76.011545



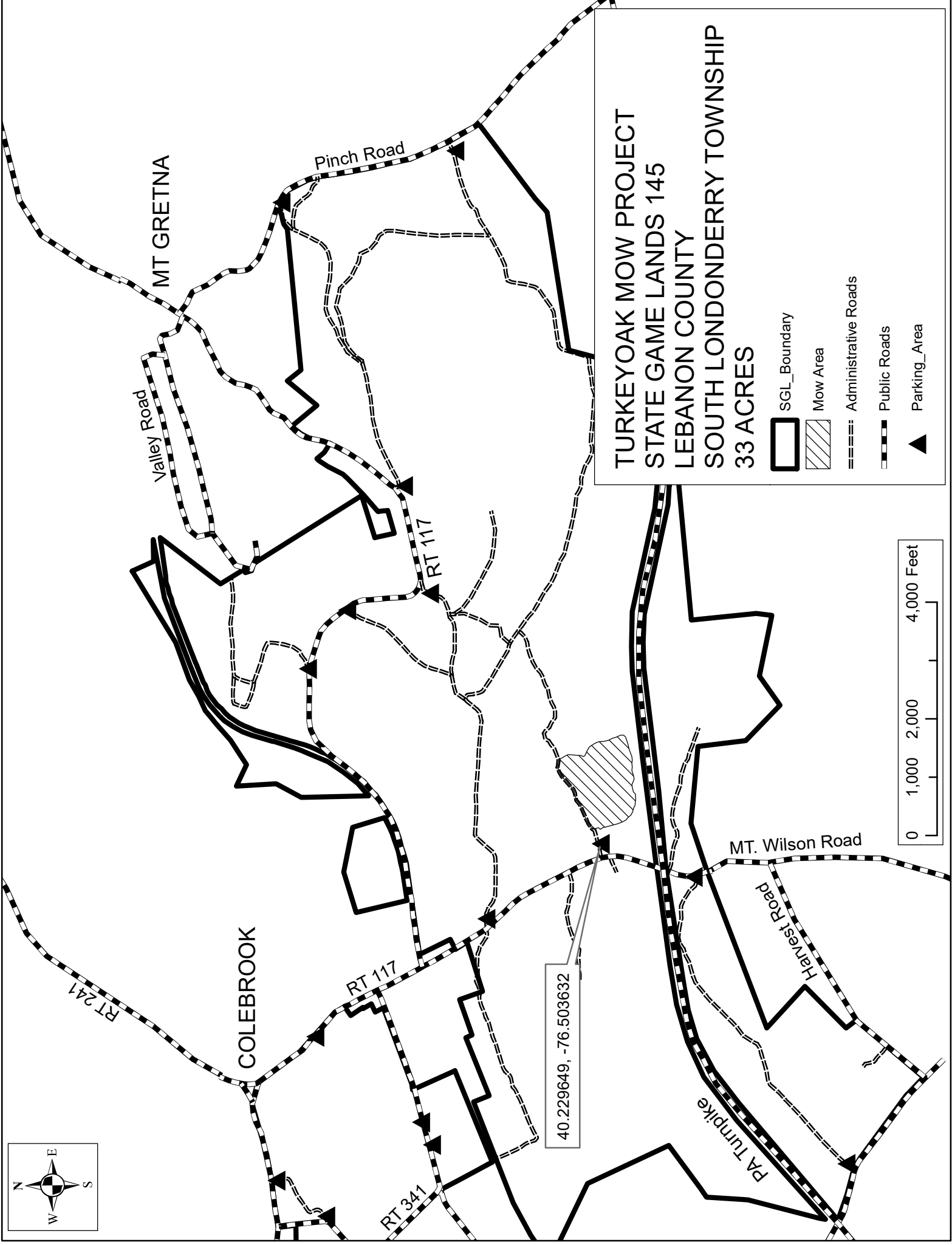

SCARECROW MOW PROJECT
STATE GAME LANDS 106
SCHUYLKILL COUNTY
WEST BRUSWICK TOWNSHIP
22 ACRES

-  SGL_Boundary
-  Mow Area
-  Trail
-  Administrative Roads
-  Parking_Area

0 375 750 1,500 Feet



TURKEYOAK MOW PROJECT
STATE GAME LANDS 145
LEBANON COUNTY
SOUTH LONDDERRY TOWNSHIP
33 ACRES

-  SGL_Boundary
-  Mow Area
-  Administrative Roads
-  Public Roads
-  Parking_Area

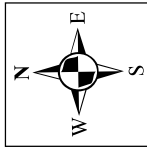
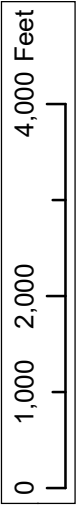

40.229649, -76.503632

MT GREYNA

Valley Road

Pinch Road

RT 117

RT 241

COLEBROOK

RT 117

RT 341

MT. Wilson Road

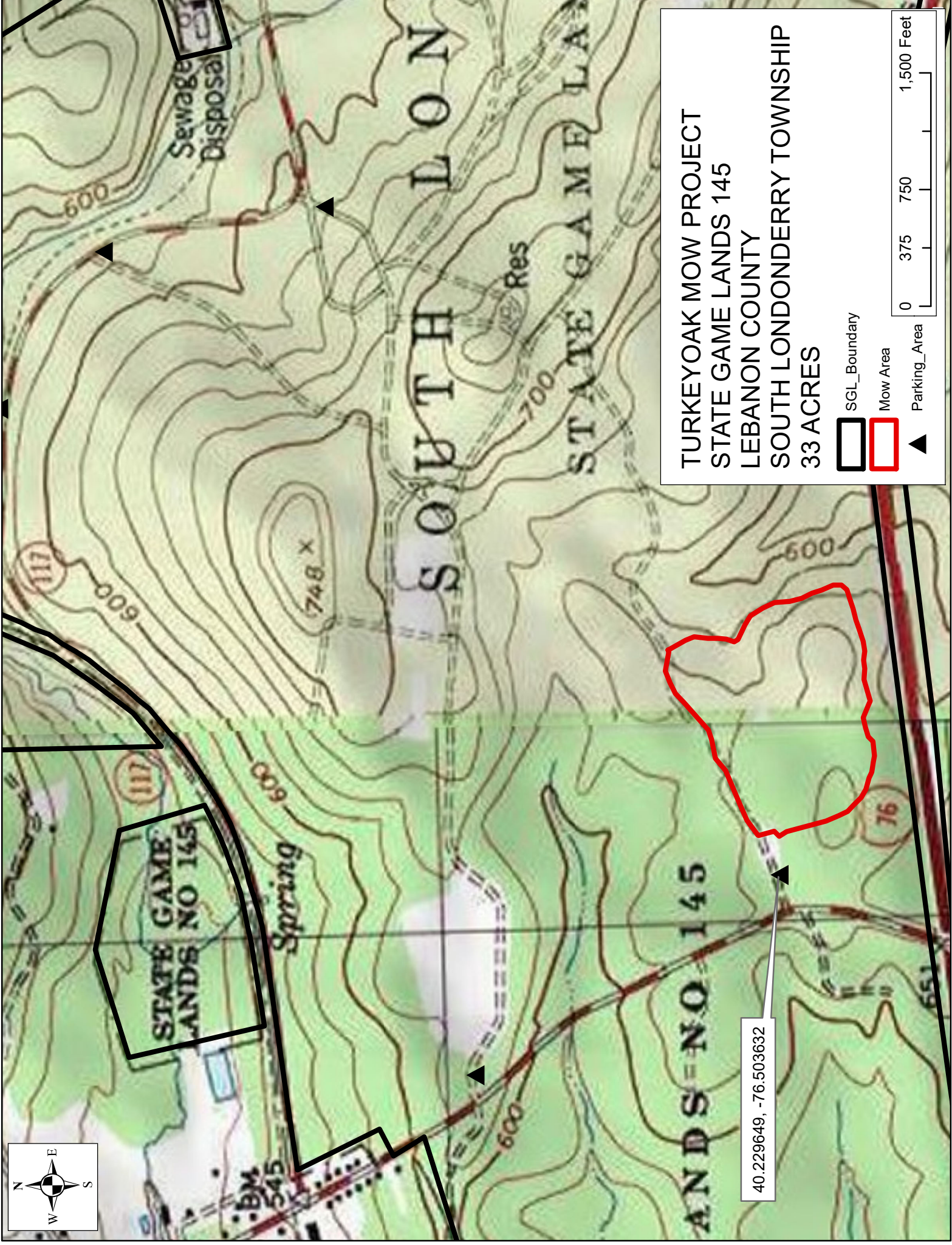

Harvest Road

PA Turnpike



TURKEYOAK MOW PROJECT
STATE GAME LANDS 145
LEBANON COUNTY
SOUTH LONDONDERRY TOWNSHIP
33 ACRES

Legend:

-  SGL_Boundary
-  Mow Area
-  Parking_Area





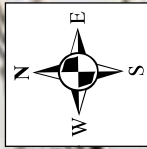

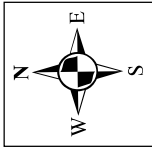
Scale: 0 375 750 1,500 Feet

40.229649, -76.503632





BITTER MOW PROJECT
STATE GAME LANDS 246
DAUPHIN COUNTY
LONDONDERRY TOWNSHIP
10 ACRES



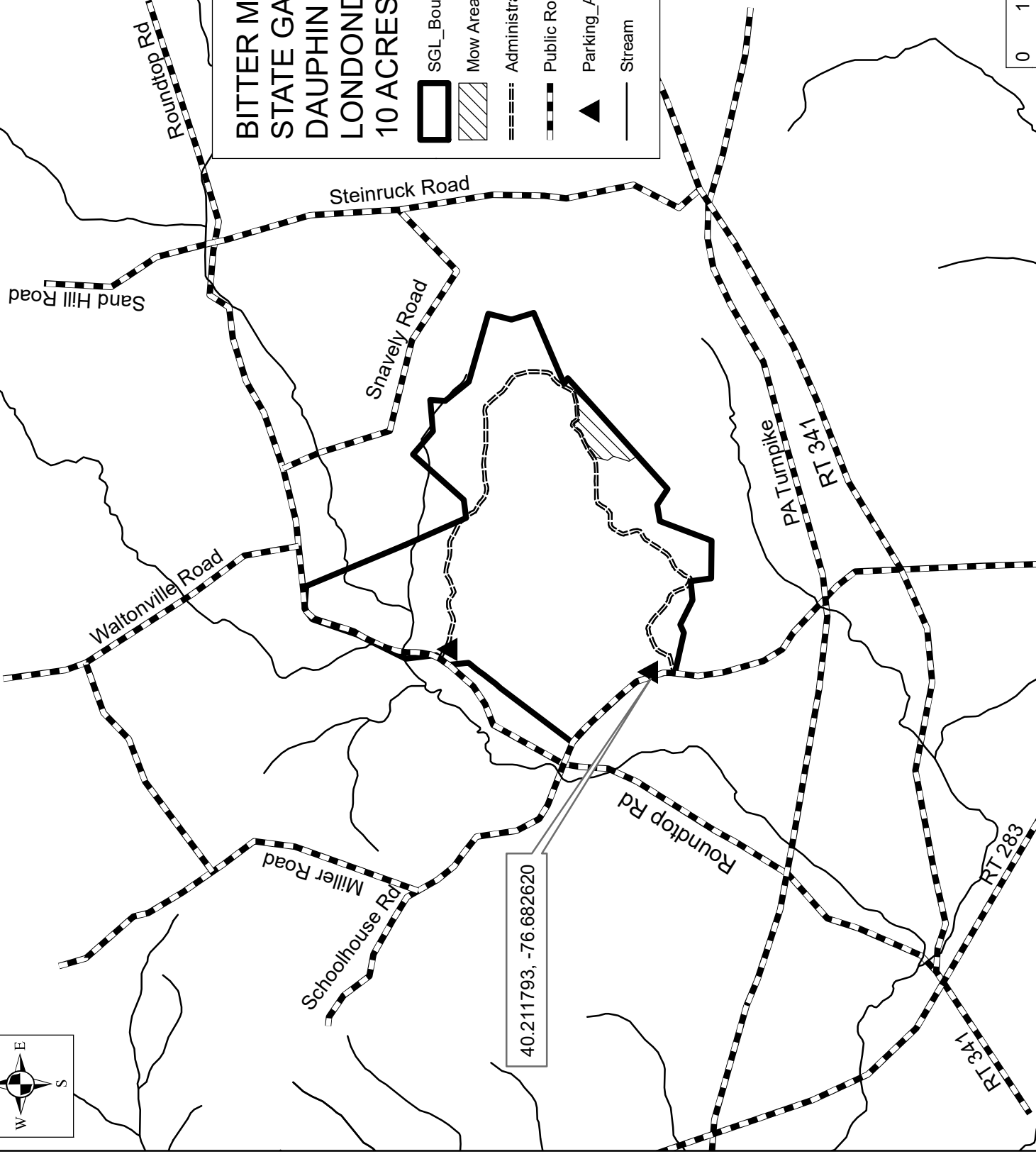

-  SGL_Boundary
-  Mow Area
-  Administrative Roads
-  Public Roads
-  Parking_Area
-  Stream

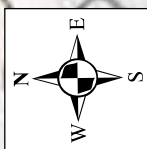

40.211793, -76.682620



BITTER MOW PROJECT
STATE GAME LANDS 246
DAUPHIN COUNTY
LONDONDERRY TOWNSHIP
10 ACRES

-  SGL_Boundary
-  Mow Area
-  Parking_Area
-  Administrative Roads

40.211793, -76.682620

